

rond 3.0 | removal tool

installation instruction

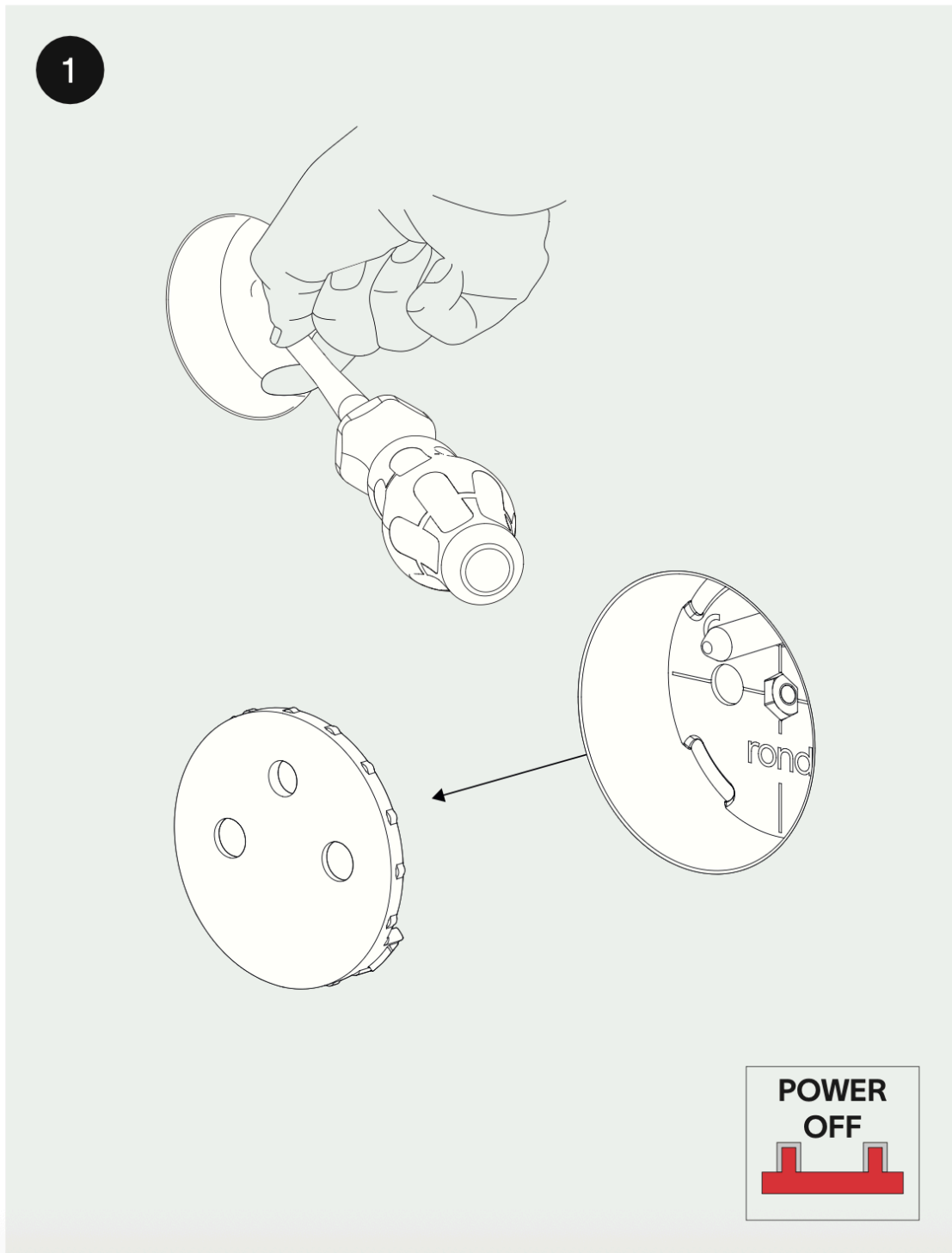

Gently remove the cover plate using a screwdriver. Place your finger between the screwdriver and the edge of the socket to prevent damaging the socket. Make sure the power is turned off before removal.

2

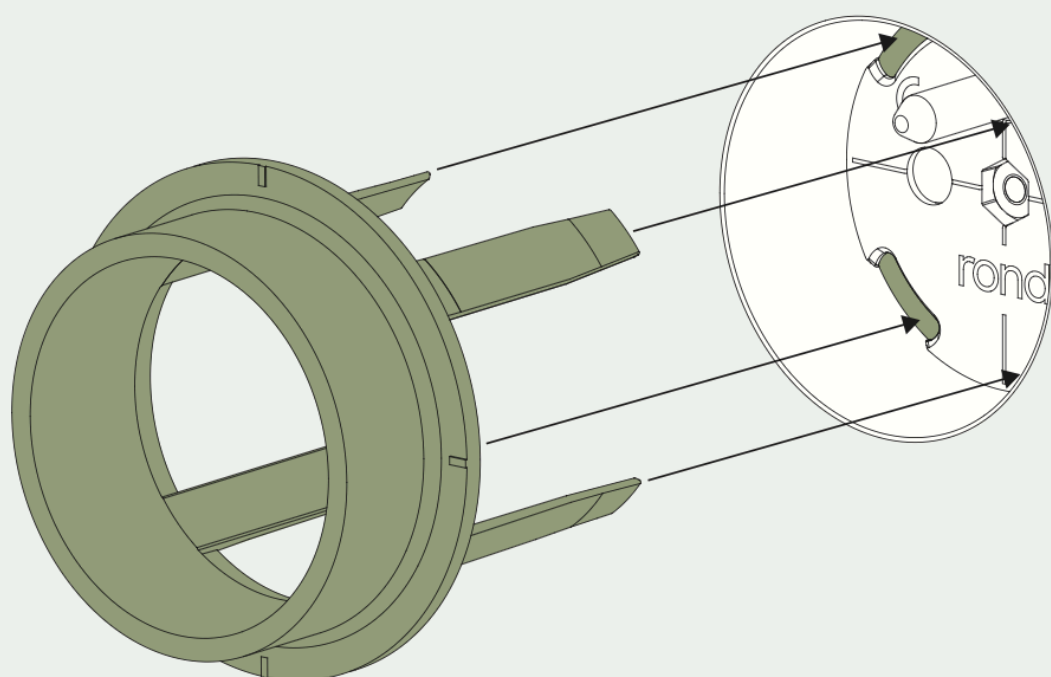

2

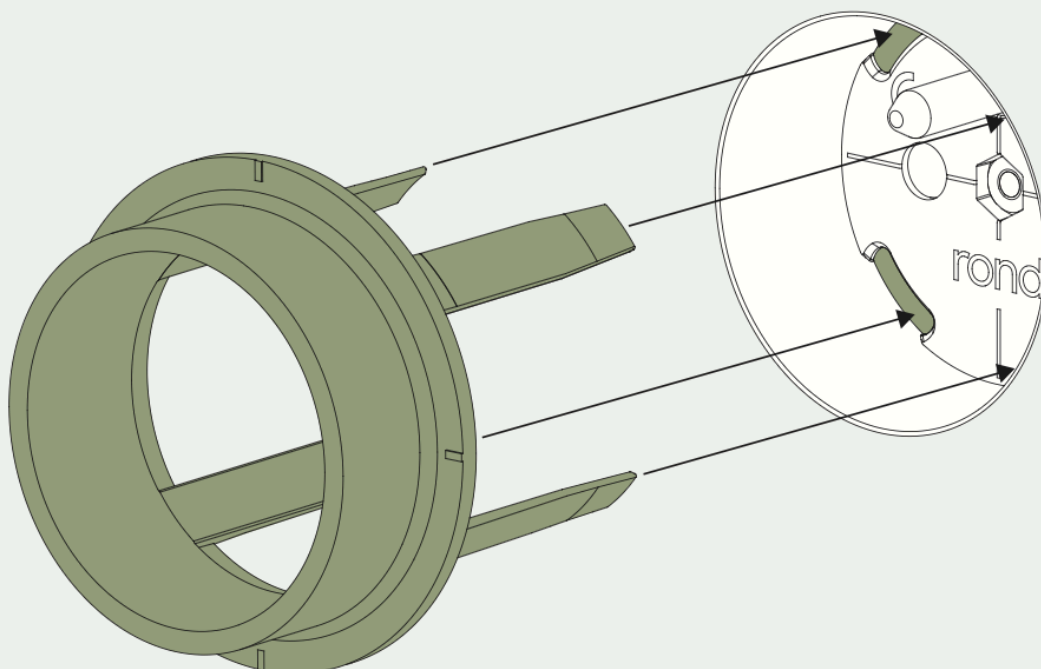

The tool's legs go through the electrical heart.

thank you for choosing rond

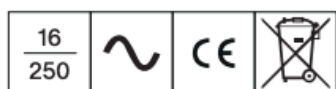

rond

×



Installation must be done by skilled professionals only and instructions must be followed at all times. Warranty will not apply in case of wrongful use of if unskilled personnel attempts to repair a product.