

rond 3.0 socket - type F

installation instruction

1

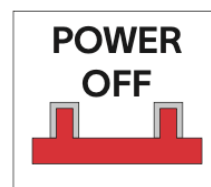
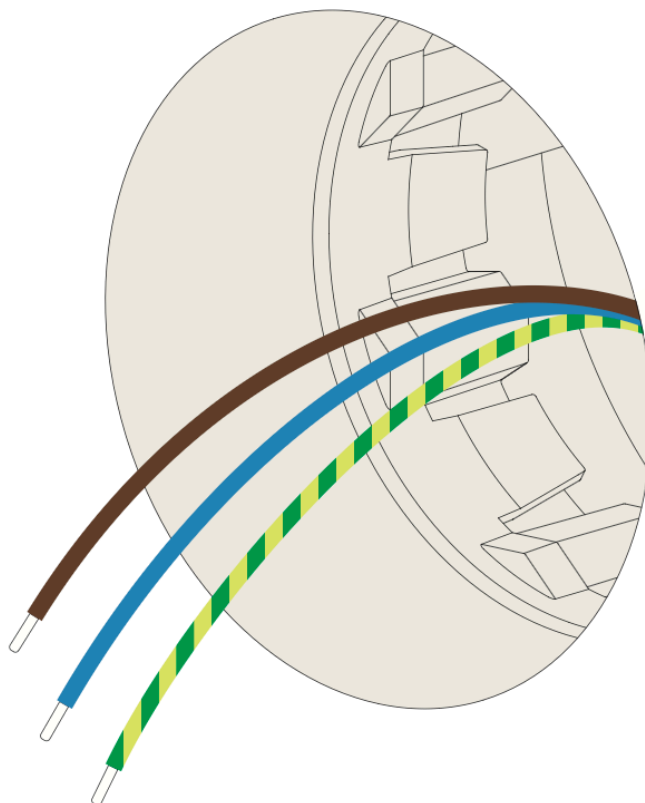

2

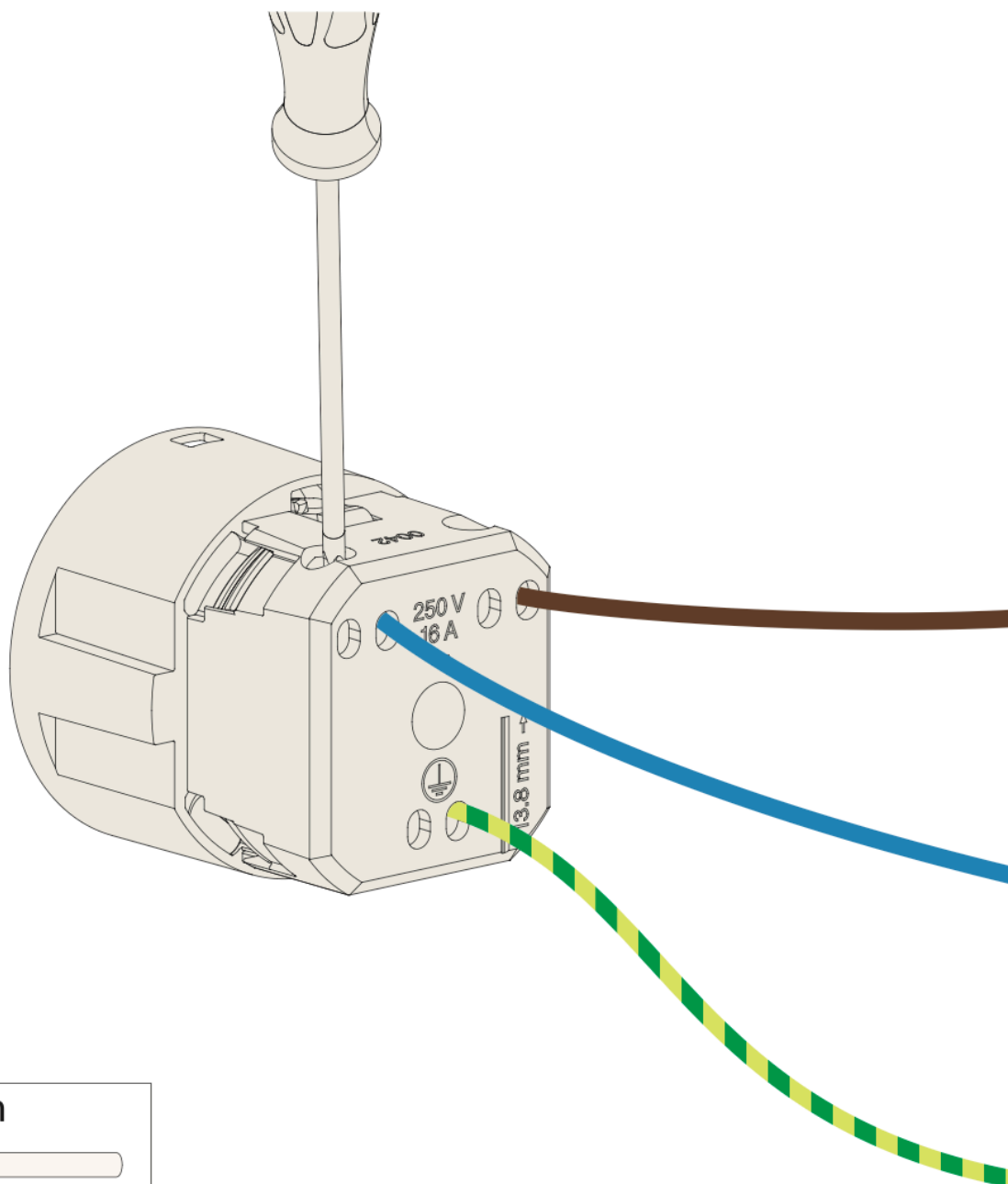

13.8 mm

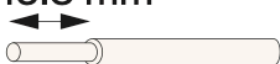

3

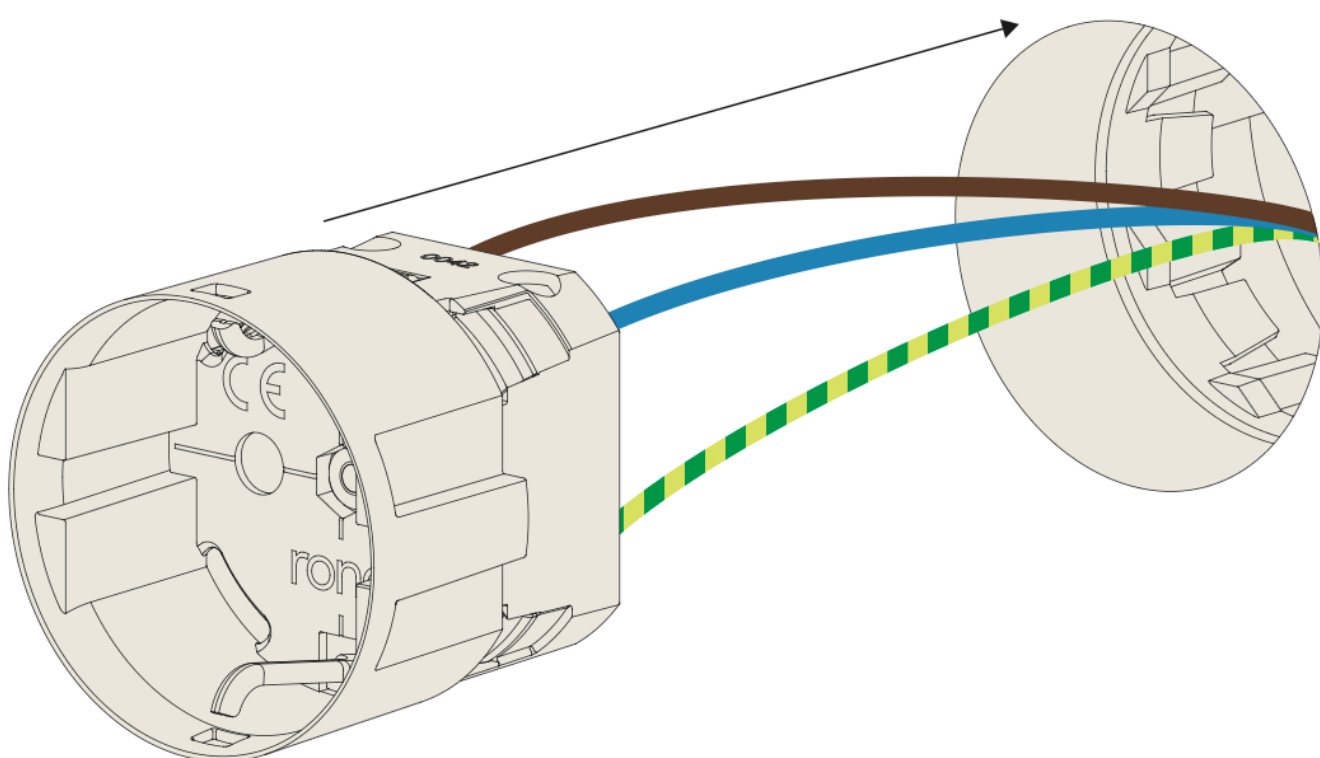

4

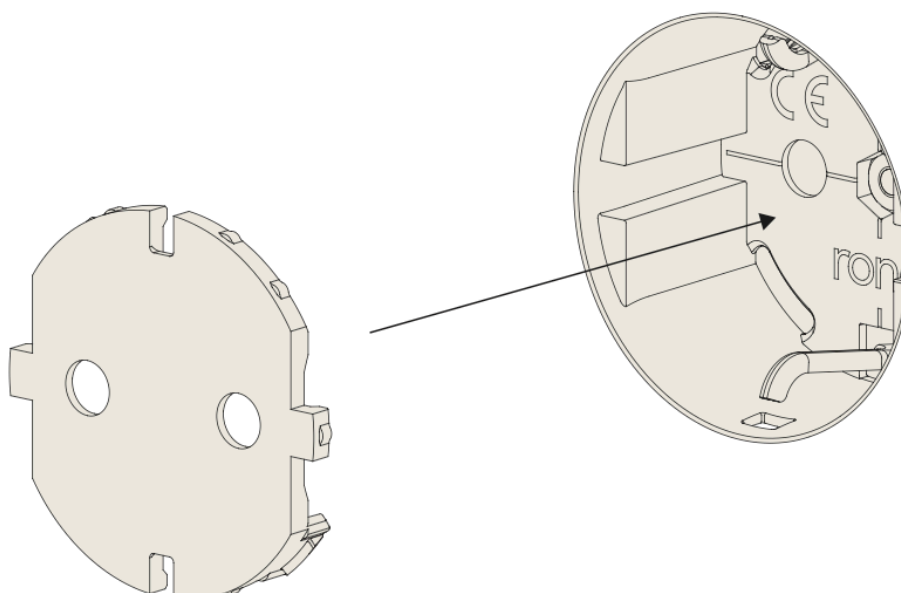

5

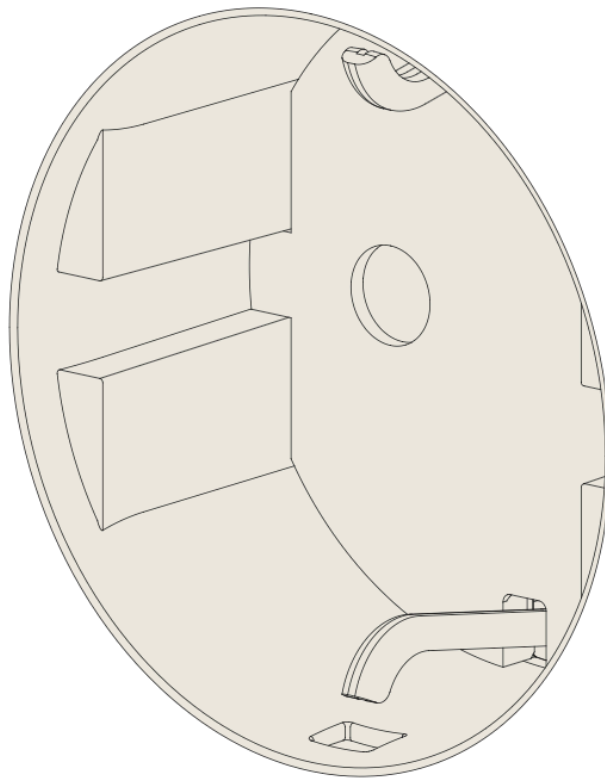

POWER
ON



For removal

1

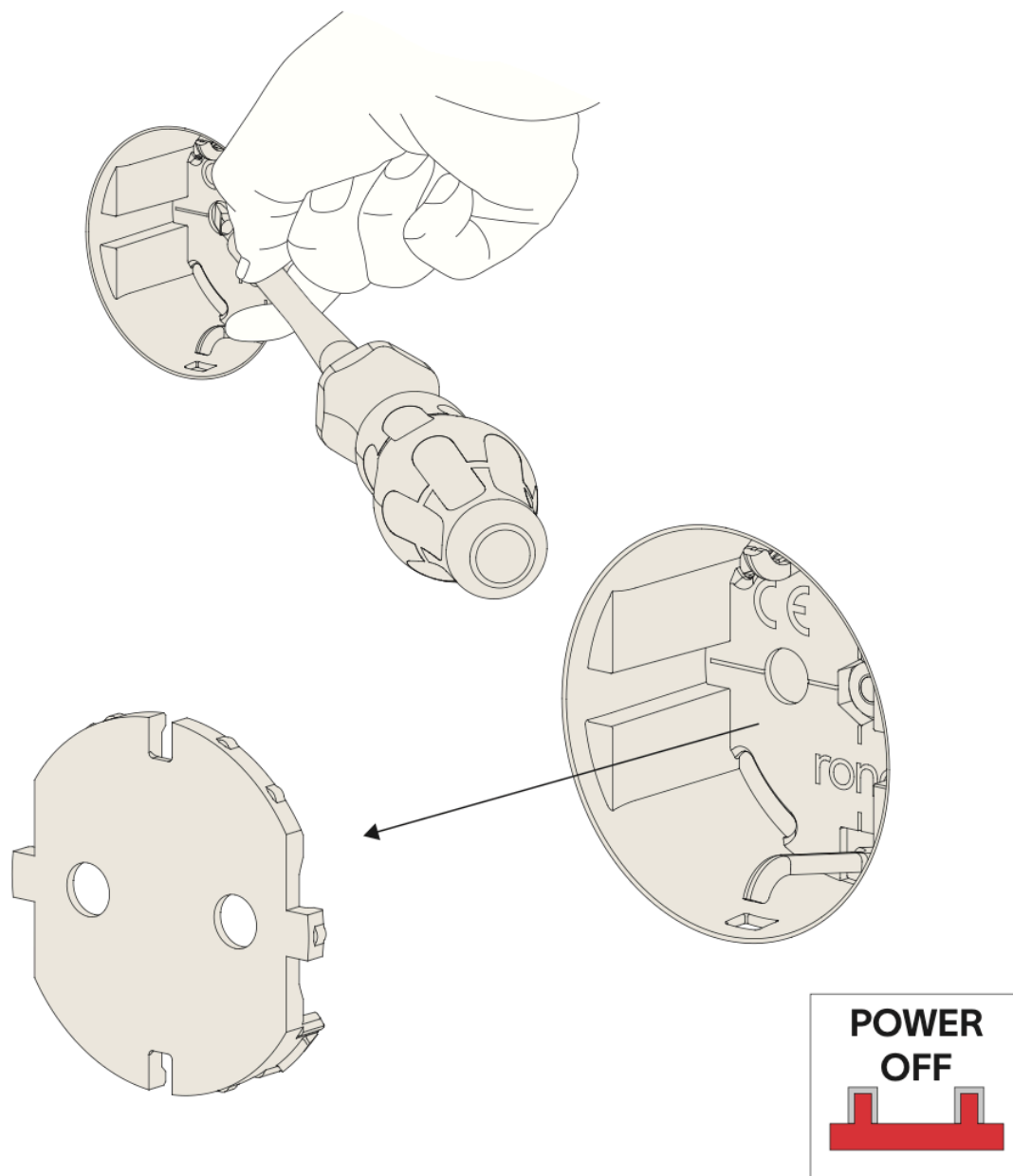

Gently remove the cover plate using a screwdriver. Place your finger between the screwdriver and the edge of the socket to prevent damaging the socket. Make sure the power is turned off before removal.

for removal

2

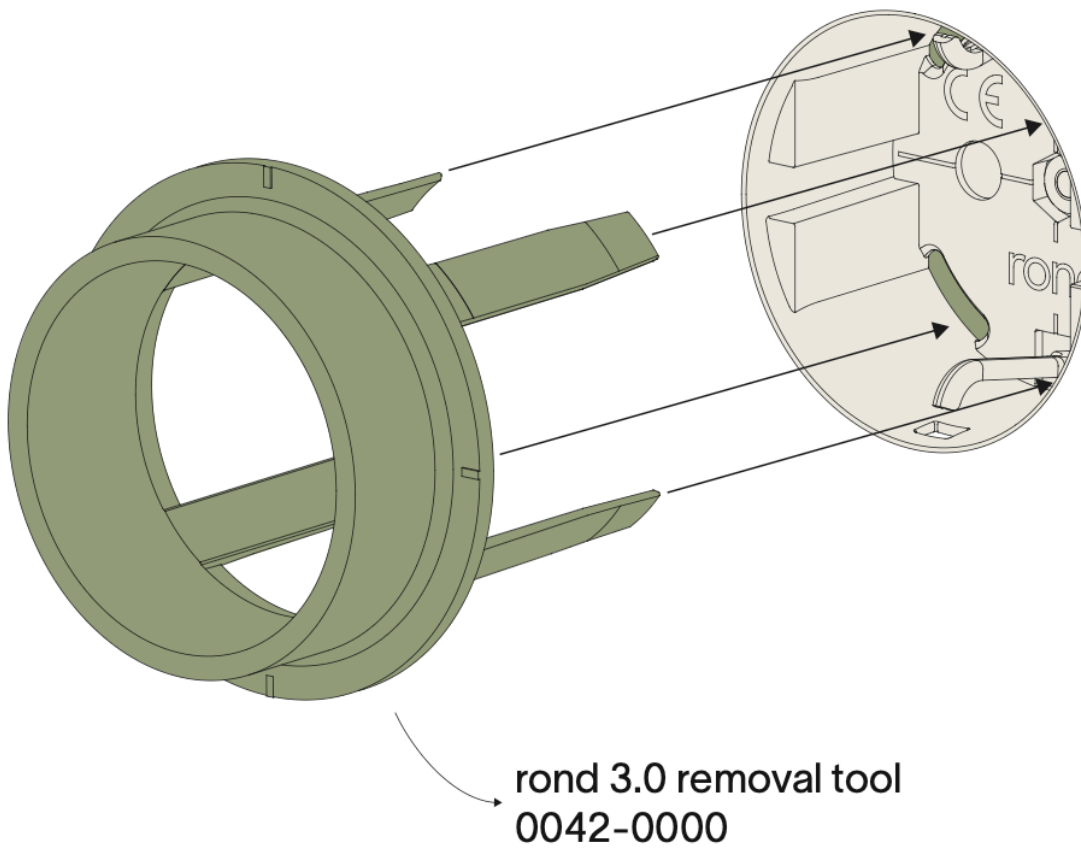

for removal

3

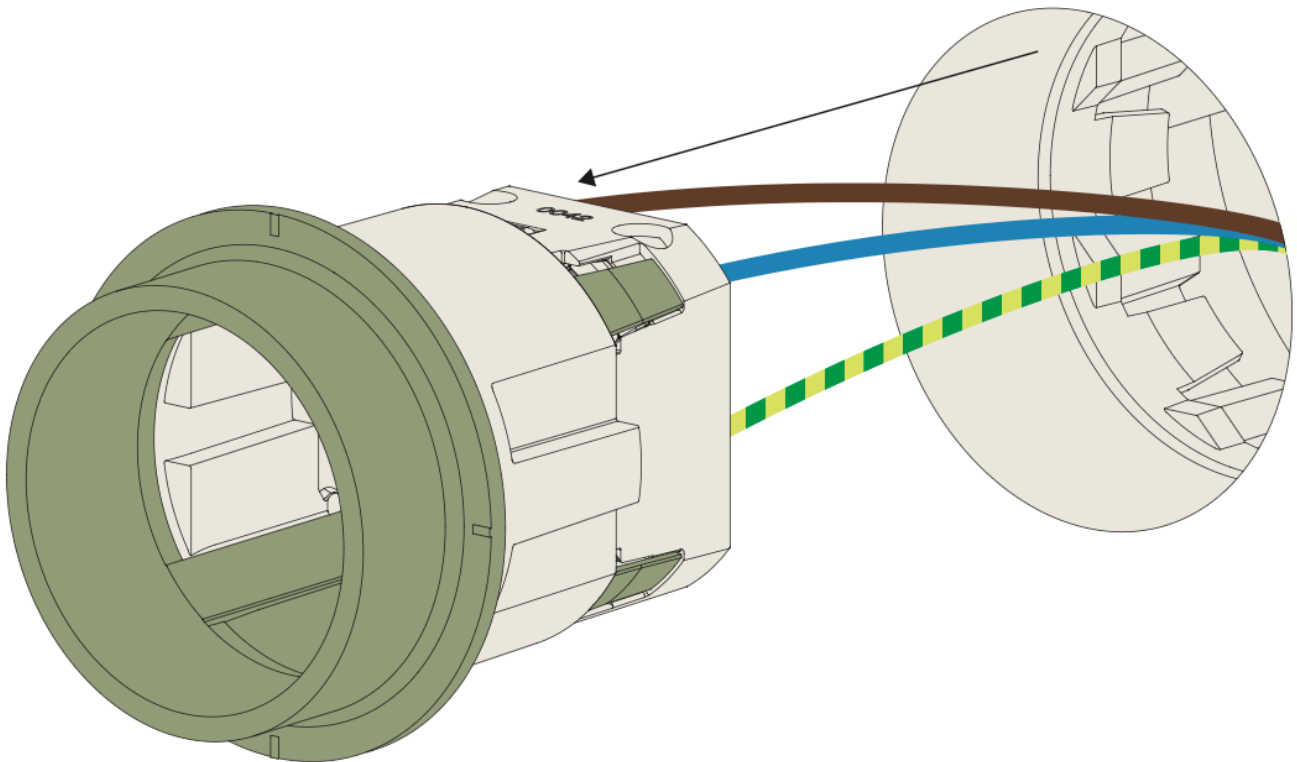

Socket model scheme

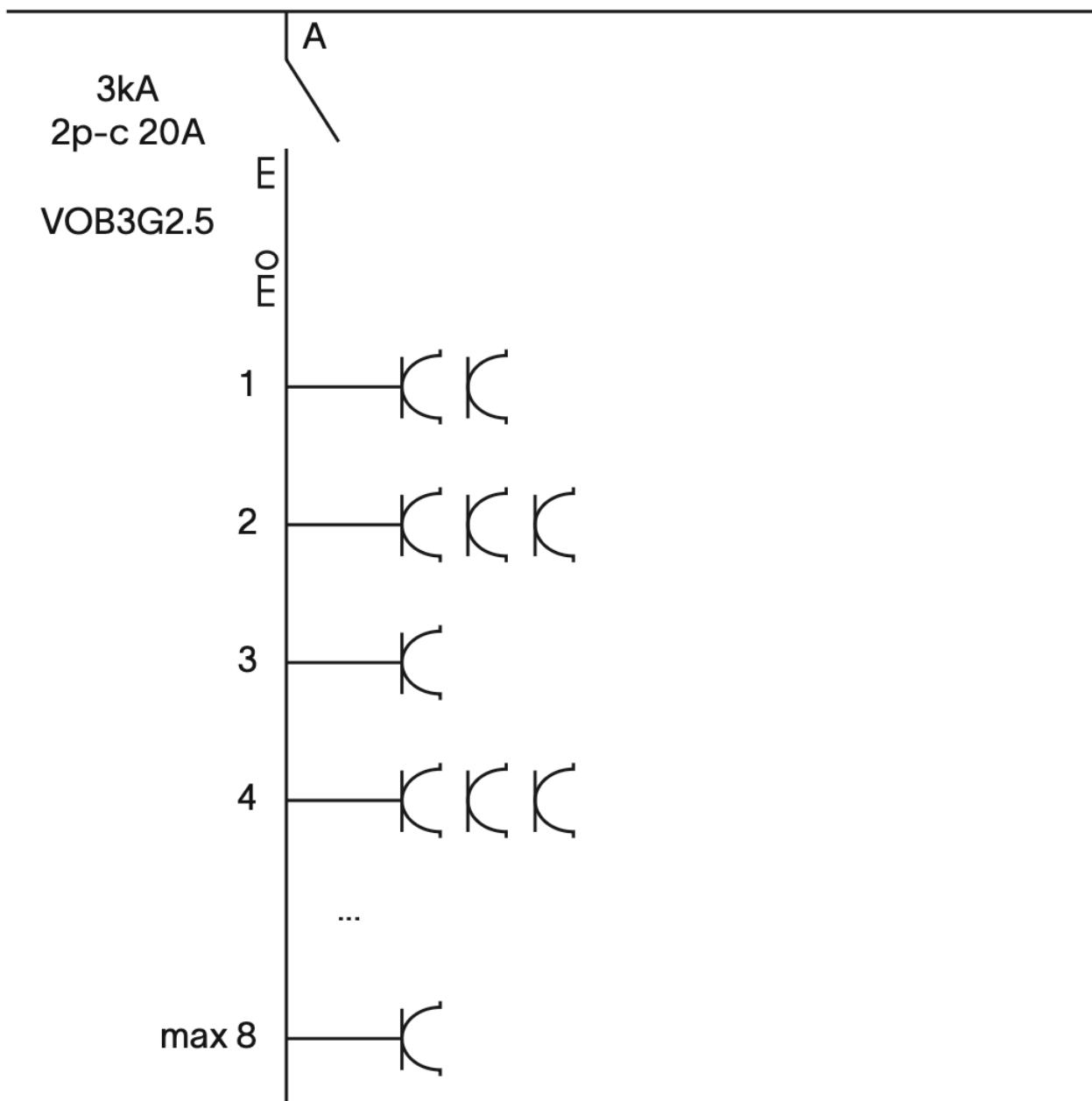

thank you for choosing rond

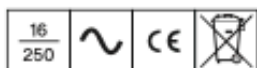

rond

×



Installation must be done by skilled professionals only and instructions must be followed at all times. Warranty will not apply in case of wrongful use of if unskilled personnel attempts to repair a product.