

# rond 3.0 backfit holder installation instruction

1

What model are you installing?

Model with flange go to step 2 ([click here](#))  
(compatible with wood, veneer, stone)

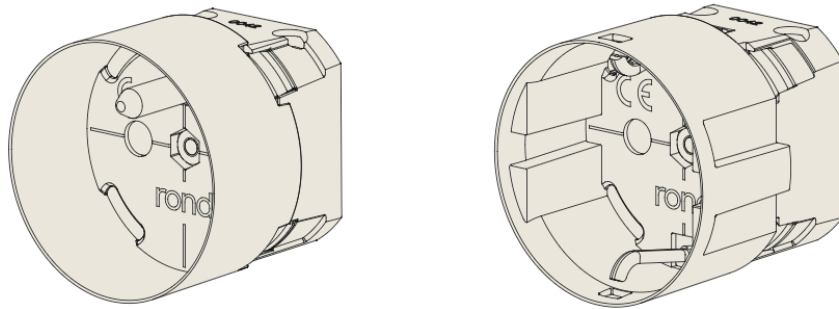

Model without flange go to step 3 ([click here](#))  
(compatible with stone only)

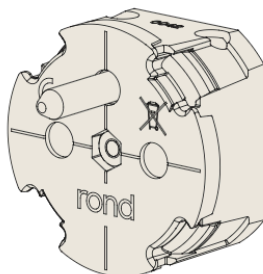

**2** model with flange

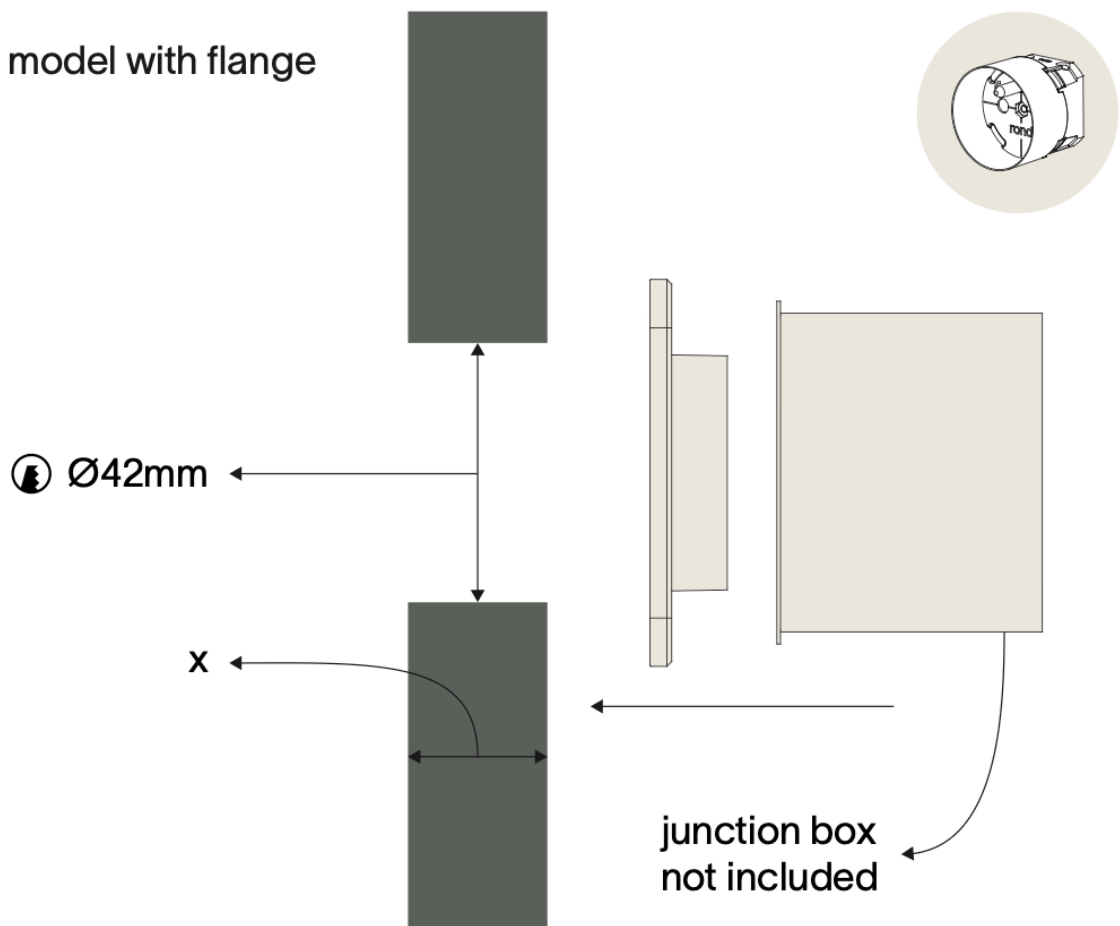

SKU	name	x
0042-0019	rond 3.0 backfit holder - 19mm	18-20mm
0042-0022	rond 3.0 backfit holder - 22mm	21-23mm

Make sure to use the correct version of the backfit holder depending on the material thickness.  
Continue to step 4. [\(click here\)](#)

3

model without flange

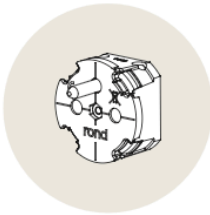

Ø40mm

x

junction box  
not included

SKU

name

x

0042-0019

rond 3.0 backfit holder - 19mm

18-20mm

0042-0022

rond 3.0 backfit holder - 22mm

21-23mm

Make sure to use the correct version of the backfit holder depending on the material thickness.

SKU	name	x
0042-0019	rond 3.0 backfit holder - 19mm	18-20mm
0042-0022	rond 3.0 backfit holder - 22mm	21-23mm

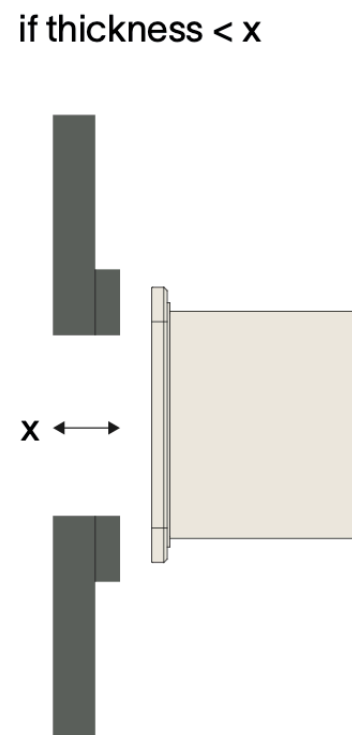
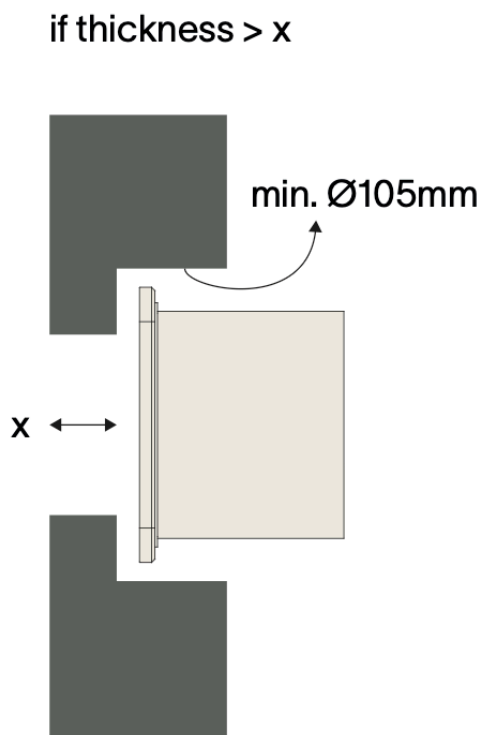

If the finish material thickness is not 19mm or 22mm (depending on chosen backfit holder), machine down or add (wooden) plate to achieve the correct total depth (19mm or 22mm).

---

5

for 2 or more

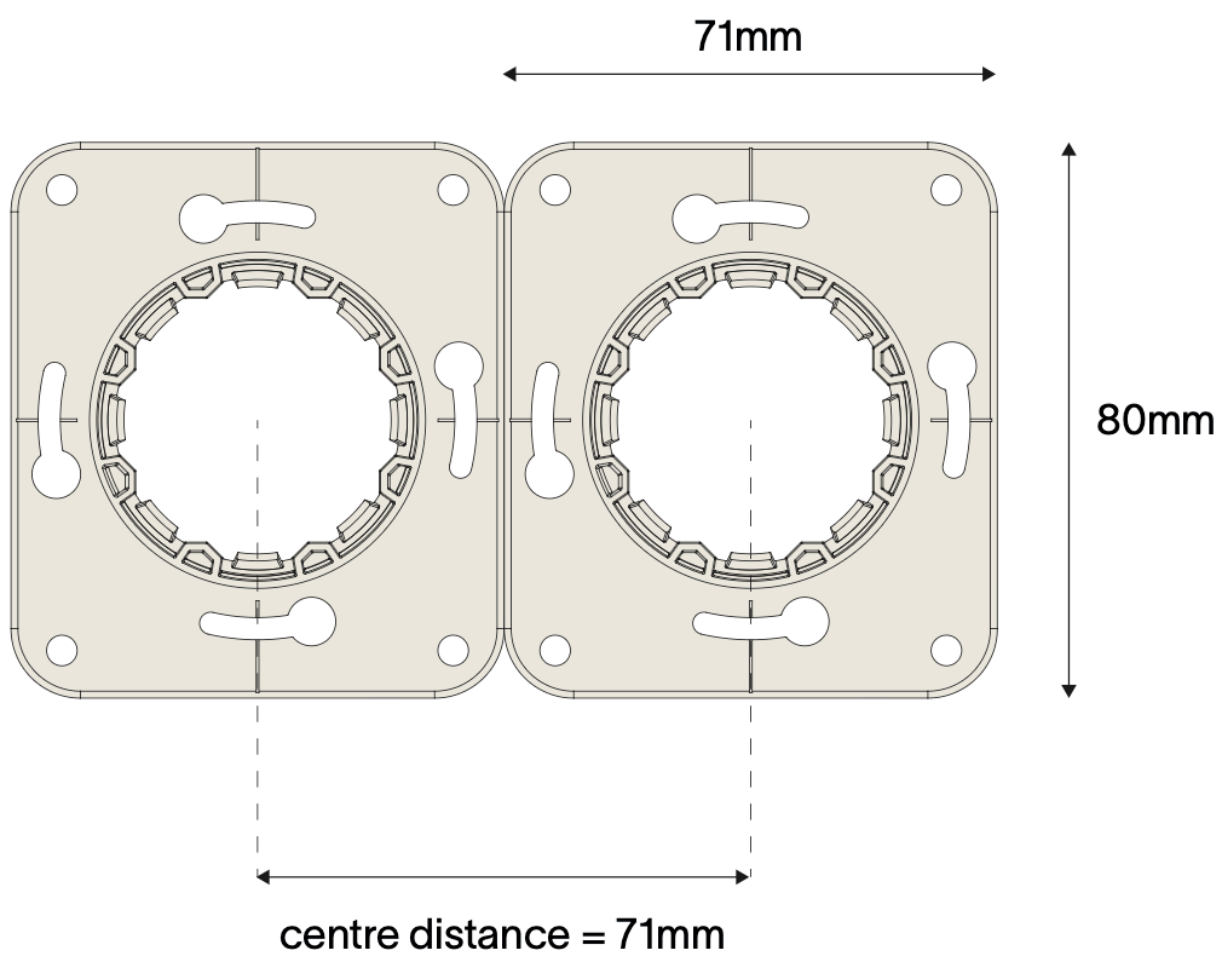

---

6

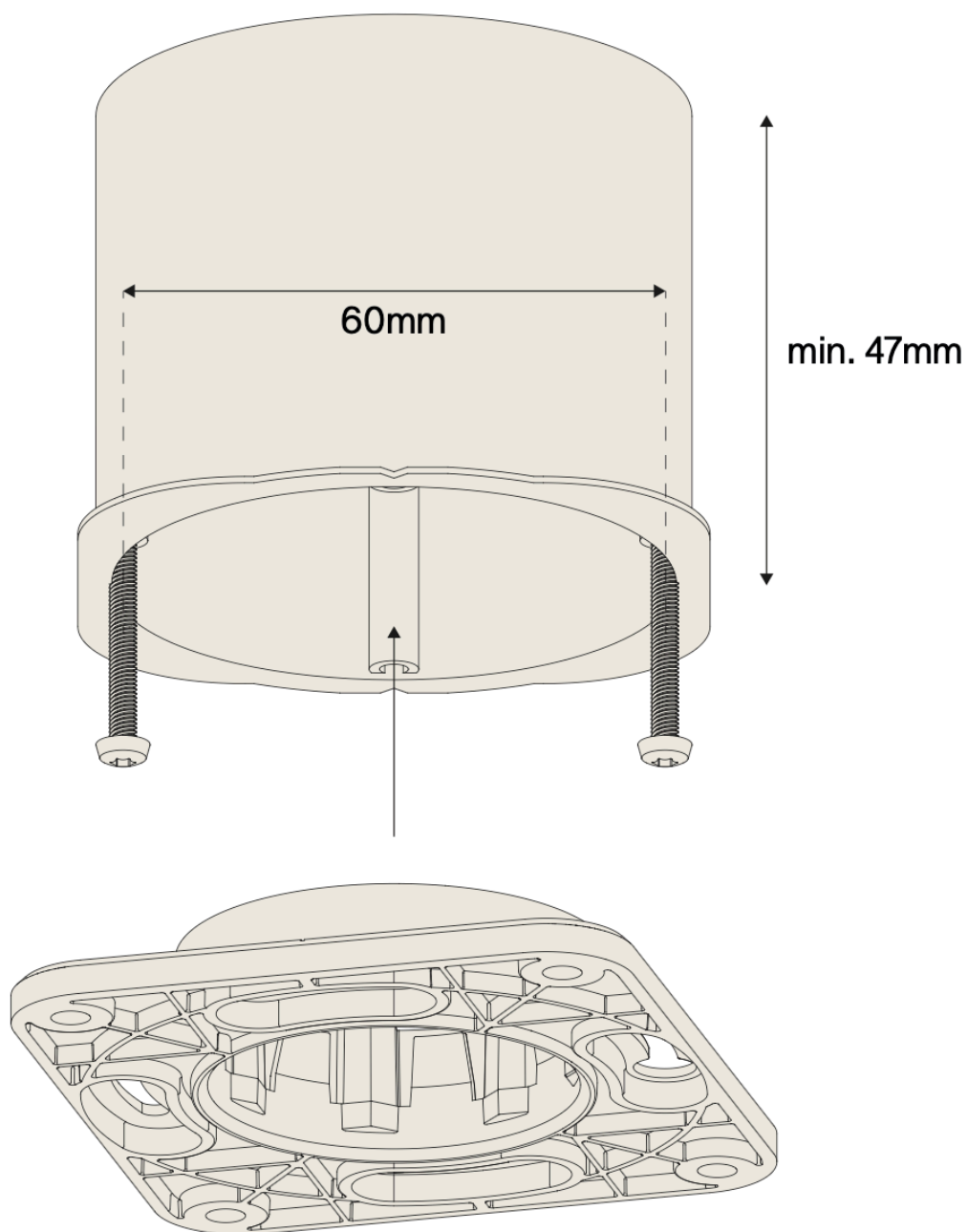

**Install the backfit holder on the junction box.**

---

---

7

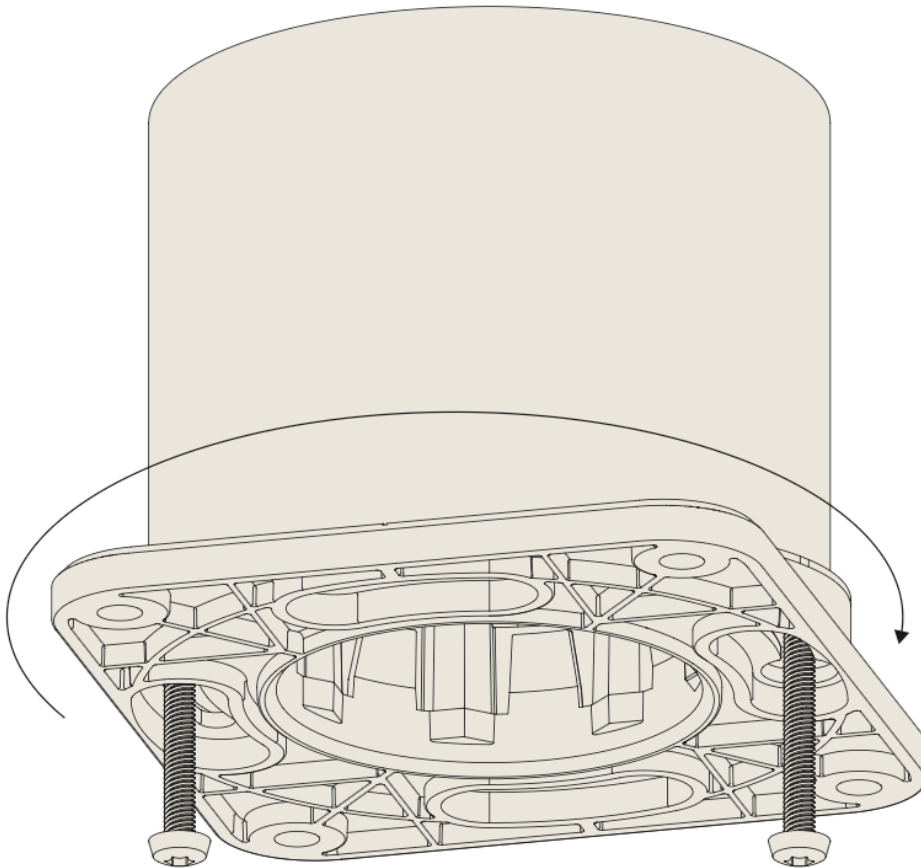

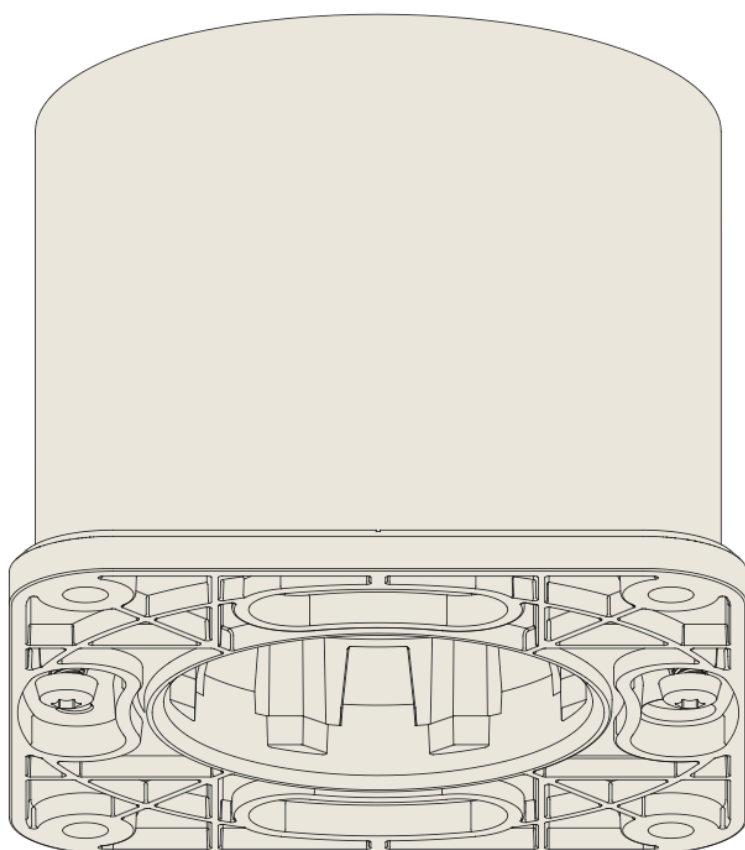



---

9

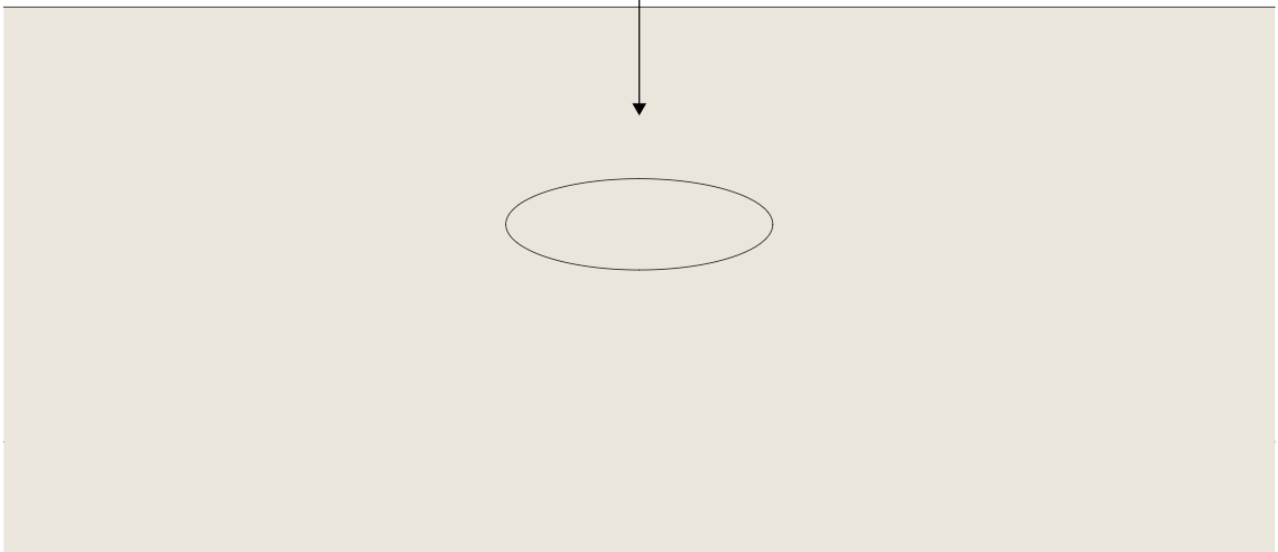
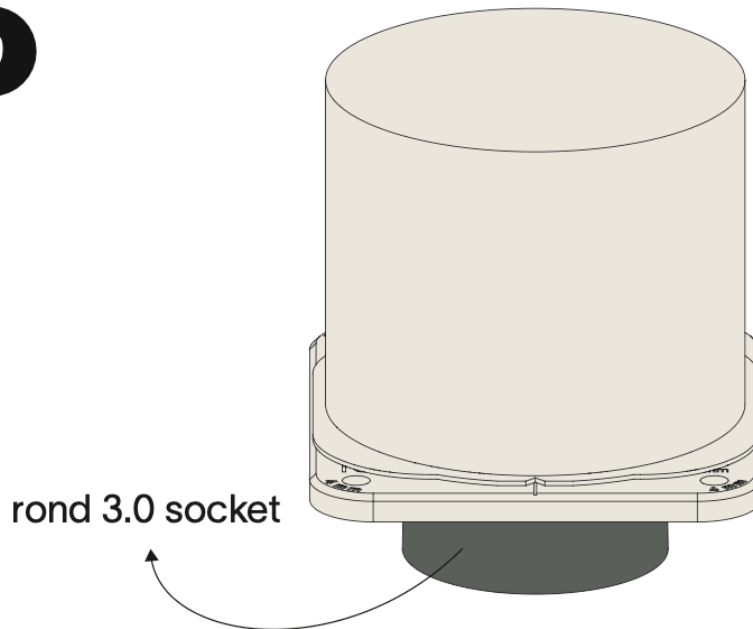

Click the socket in the holder to make alignment easier.

---

---

10

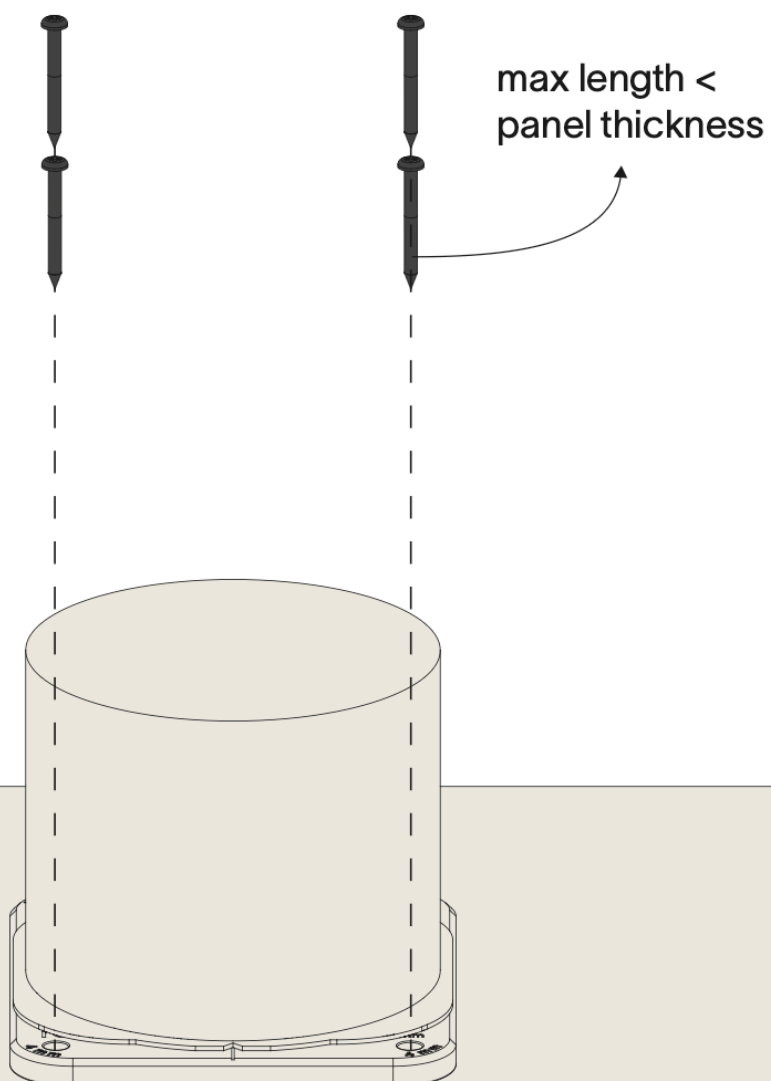

Fasten the backfit holder with junction box securely at the back of the material with the appropriate glue or screws on a screwfast surface.

11

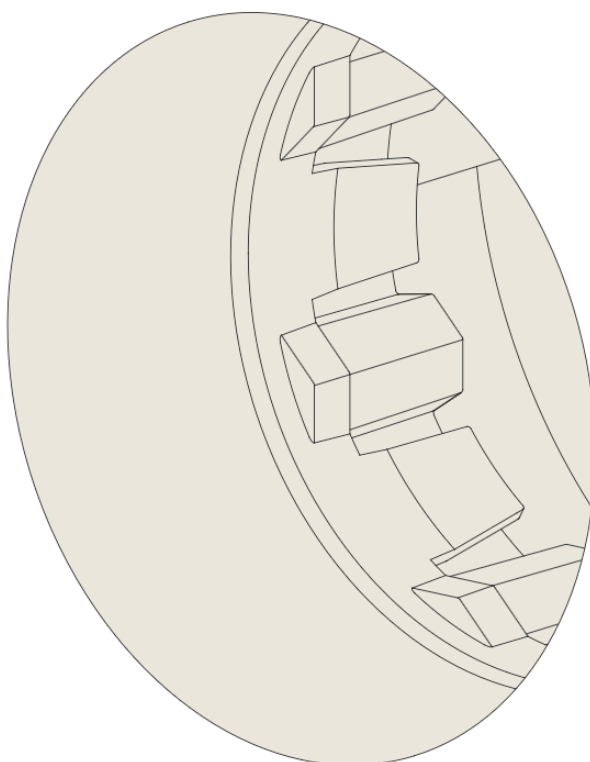

Remove the socket using the removal tool and follow the socket installation manual. The backfit holder is compatible with rond 3.0 retro / backfit / stone socket.

thank you for choosing rond

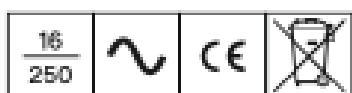

rond

×



Installation must be done by skilled professionals only and instructions must be followed at all times. Warranty will not apply in case of wrongful use of if unskilled personnel attempts to repair a product.